

**BEFORE THE ILLINOIS POLLUTION CONTROL BOARD**

Probst Grain & Livestock )  
(Property Identification Number ) PCB No. 21-  
58-06-09-400-002 ) (Tax Certification)  
)

**NOTICE**

**PLEASE TAKE NOTICE** that I have today filed with the Office of the Clerk of the Pollution Control Board an APPEARANCE and RECOMMENDATION OF THE ILLINOIS ENVIRONMENTAL PROTECTION AGENCY, copies of which are herewith served upon you.

Probst Grain & Livestock-Wheeler  
Randall Probst  
1977 E. 1500th Ave.  
Wheeler, Illinois 62479

Don Brown, Clerk  
Illinois Pollution Control Board  
James R. Thompson Center  
100 West Randolph Street, Suite 11-500  
Chicago, Illinois 60601

**Copies also provided electronically as follows:**

Illinois Department of Revenue  
via email at REV.PropTaxApp@illinois.gov  
101 West Jefferson  
P.O. Box 19033  
Springfield, Illinois 62794

ILLINOIS ENVIRONMENTAL PROTECTION AGENCY

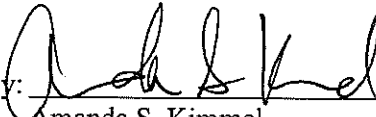
By:   
Amanda S. Kimmel  
Assistant Counsel  
Division of Legal Counsel

DATED: January 8, 2021

Illinois Environmental Protection Agency  
1021 North Grand Avenue East  
Post Office Box 19276  
Springfield, Illinois 62794-9276  
(217) 782-5544

**THIS FILING IS SUBMITTED ON RECYCLED PAPER**

**BEFORE THE ILLINOIS POLLUTION CONTROL BOARD**

**Probst Grain & Livestock** )  
**(Property Identification Number** ) **PCB No. 21-**  
**58-06-09-400-002)** ) **(Tax Certification)**  
 )

**A P P E A R A N C E**

The undersigned, as one of its attorneys, hereby enters an APPEARANCE on behalf of Respondent, Illinois Environmental Protection Agency.

ILLINOIS ENVIRONMENTAL PROTECTION AGENCY

By:  \_\_\_\_\_  
Amanda S. Kimmel  
Assistant Counsel  
Division of Legal Counsel

DATED: January 8, 2021

Illinois Environmental Protection Agency  
1021 North Grand Avenue East  
Post Office Box 19276  
Springfield, Illinois 62794-9276  
(217)782-5544

**THIS FILING IS SUBMITTED ON RECYCLED PAPER**

**BEFORE THE ILLINOIS POLLUTION CONTROL BOARD**

**Probst Grain & Livestock** )  
**(Property Identification Number** ) **PCB No. 21-**  
**58-06-09-400-002)** ) **(Tax Certification)**  
)

**RECOMMENDATION OF THE ILLINOIS**  
**ENVIRONMENTAL PROTECTION AGENCY**

The Illinois Environmental Protection Agency ("Illinois EPA") hereby files its Recommendation pursuant to Section 125.204 of the regulations of the Illinois Pollution Control Board ("Board"), 35 Ill. Adm. Code 125.204.

1. On December 26, 2017 and supplemented on August 13 and 17, 2020, the Illinois EPA received a request from Probst Grain & Livestock (log number TC-139041, Exhibit A) for an Illinois EPA recommendation regarding the tax certification of water pollution control facilities pursuant to 35 Ill. Adm. Code 125.204.
2. The facility's address is: Probst Grain & Livestock  
2765 E. 1400th Ave.  
Wheeler, Illinois 62479

The proposed water pollution control facilities in this request are located in the SE ¼ of Section 9, T7N, R8E of the 3rd P.M. in Jasper County, at the above street address and consist of the following:

Livestock waste handling facilities consisting of one concrete manure stacking area (approximately 159 ft. x 55 ft. x 6 ft.), and the portion of the building over the manure stacking area.

These livestock waste management facilities are used to collect, transport, and/or store livestock waste prior to cropland application, and are further described in Exhibit A.

3. Section 11-10 of the Property Tax Code, 35 ILCS 200/11-10 (2018), and Section 125.200(a) of the Board's regulations, 35 Ill. Adm. Code 125.200(a), define "pollution control facilities" as:

any system, method, construction, device or appliance appurtenant thereto or any portion of any building or equipment, that is designed, constructed, installed or operated for the primary purpose of: eliminating, preventing, or reducing air or water pollution ...or treating, pretreating, modifying or disposing of any potential solid, liquid or gaseous pollutant which if released without treatment, pretreatment modification or disposal might be harmful, detrimental or offensive to human, plant or animal life, or to property.

4. In order to receive preferential tax treatment as pursuant to 35 ILCS 200/11-5 (2018), pollution control facilities must be certified as such by the Board, 35 ILCS 200/11-20 (2018) and 35 Ill. Adm. Code 125.200(a).
5. Upon receipt of a tax certification application, the Illinois EPA must file a recommendation on the application with the Board, 35 Ill Adm. Code 125.204(a).
6. Based on the information in the application and the purpose of the facility, it is the Illinois EPA's engineering judgment that the described facilities may be considered "pollution control facilities," pursuant to 35 Ill. Adm. Code 125.200(a), with the primary purpose of eliminating, preventing, or reducing water pollution, or as otherwise provided in 35 Ill. Adm. Code 125.200, and are eligible for tax certification from the Board.

WHEREFORE, the Illinois EPA recommends that the Board issue the requested tax certification.

ILLINOIS ENVIRONMENTAL PROTECTION AGENCY

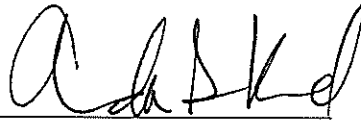
By:   
Amanda S. Kimmel  
Assistant Counsel  
Division of Legal Counsel

Dated: January 8, 2021

Illinois Environmental Protection Agency  
1021 North Grand Ave. E.  
P.O. Box 19276  
Springfield, Illinois 62794-9276  
217/782-5544



## ILLINOIS ENVIRONMENTAL PROTECTION AGENCY

1021 NORTH GRAND AVENUE EAST, P.O. BOX 19276, SPRINGFIELD, ILLINOIS 62794-9276 • (217) 782-3397

JB PRITZKER, GOVERNOR

JOHN J. KIM, DIRECTOR

# Memorandum

To: Mike Roubitchek, Division of Legal Counsel

From: Darin E. LeCrone, Manager, Industrial Unit, Permit Section

*DEL*

Date: OCT 21 2020

Re: Probst Grain & Livestock – Wheeler  
Recommendation of Tax Certification  
Log# TC-139041  
Property Index# 58-06-09-400-002

---

The Bureau of Water received a request on December 26, 2017 from Randall Probst for an Illinois EPA recommendation regarding the tax certification of water pollution control facilities pursuant to 35 Ill. Adm. Code 125.204. We offer the following recommendation.

The water pollution control facilities in this request include the following:

Probst Grain & Livestock  
2765 E. 1400<sup>th</sup> Ave.  
Wheeler, IL 62479

SE ¼ of Section 9, T7N, R8E of the 3<sup>rd</sup> PM in Jasper County

The livestock waste handling facilities consisting of one (1) concrete manure stacking area (approximately 159 ft. x 55 ft. x 6 ft.), and the portion of the building over the manure stacking area. The facility collects, transports and stores livestock waste prior to cropland application.

The facility is further described in the enclosed applications and supporting documents.

Based on the information included in this submittal, it is our engineering judgment that the above proposed facilities may be considered "Pollution Control Facilities" under 35 IAC 125.200(a), with the primary purpose of eliminating, preventing, or reducing water pollution, or as otherwise provided in this section, and therefore eligible for tax certification from the Illinois Pollution Control Board. The Bureau of Water therefore recommends that the Board issue the requested tax certification for these facilities.

If you have any questions regarding the above, please contact Wei Han at 217/782-0610.

DEL:WH:Tax Cert Recommendation.docx

cc: Tax Cert File

2125 S. First Street, Champaign, IL 61820 (217) 278-5800  
2009 Mall Street Collinsville, IL 62234 (618) 346-5120  
9511 Harrison Street, Des Plaines, IL 60016 (847) 294-4000  
595 S. State Street, Elgin, IL 60123 (847) 608-3131

2309 W. Main Street, Suite 116, Marion, IL 62959 (618) 993-7200  
412 SW Washington Street, Suite D, Peoria, IL 61602 (309) 671-3022  
4302 N. Main Street, Rockford, IL 61103 (815) 987-7760

Electronic Filing: Received, Clerk's Office 1/8/2021 \*\*PCB 2021-052\*\*  
Watershed Unit Tax Certification Review Sheet

Project Name: Probst Grain & Livestock

Date: August 21, 2020

Type:  Agchem  
 Livestock

Reviewer: WH

Contact:

Log number: TC-139041

Applicant: Randall Probst  
1977 E. 1500<sup>th</sup> Ave.  
Wheeler, IL 62479

Phone: 217-925-5120

Property Index#: 58-06-09-400-002

Facility: Probst Grain & Livestock  
2765 E. 1400<sup>th</sup> Ave.  
Wheeler, IL 62479

Parcel#:

County: Jasper

Legal Description:

SW ¼ of Section: 9 Twp: 7N R: 8E PM: 3<sup>rd</sup>

Signature: Chris Probst

Title: V.P.

Date Control Devices installed: November 2015

Wastes:  Livestock waste is applied to cropland.  
 Agrichemical rinsate and spillage is recycled through the facility and/or land applied.  
 Other: \_\_\_\_\_

Physical Description of Pollution Control Devices:

The livestock waste handling facilities consist of one (1) concrete manure stacking area (approximately 159 ft. x 55 ft. x 6 ft.) and the portion of the building over the manure stacking area. The facility collects, transports and stores livestock waste prior to cropland application.

Pollution control facilities requested by the applicant through Description of Pollution Control Facilities, Section 2 of the application form:

One (1) concrete manure stacking area (159 ft. x 55 ft. x 6 ft.)  
Portion of the building over the manure stacking area;

A process flow diagram with narrative is provided by the attachment of the application.

An updated plan view drawing is provided via email of 8/17/2020.

Recommended Action: Issue tax certification.

**Han, Wei**

---

**From:** Jake Nims <jnims@fwieng.com>  
**Sent:** Monday, August 17, 2020 12:59 PM  
**To:** Han, Wei  
**Subject:** RE: [External] Probst Grain & Livestock TC-139041  
**Attachments:** 124199 09-08-15 Foundation Set.pdf

Mr. Han,

The drawings are somewhat confusing because the plan view is broken down into the first two pages of the attached file. The "match line" of the two drawings runs through the middle of the manure stacking area. I believe the drawings show the correct dimensions, but it is somewhat confusing. I've attached revised drawings that include a note that shows the manure stacking area on both Page 1 and 2.

Please let me know if you have any further questions.

Jake Nims  
Frank & West Environmental Engineers, Inc.  
1032 S. 2nd St.  
Springfield, IL 62704  
(217) 679-7361 office  
(217) 679-8362 fax  
(309) 530-2894 cell

---

**From:** Han, Wei [mailto:Wei.Han@Illinois.gov]  
**Sent:** Friday, August 14, 2020 5:17 PM  
**To:** Jake Nims  
**Subject:** RE: [External] Probst Grain & Livestock TC-139041

Mr. Nims,

The drawings did not specifically show the manure stacking area with dimensions provided in the application form. Please revise the drawing that clearly marks "manure stacking area" at the location and the dimensions.

Wei Han, P.E.  
Illinois Environmental Protection Agency  
BOW/DWPC/Permit Section  
1021 North Grand Avenue E.  
P.O. Box 19276  
Springfield, IL 62794-9276

Phone: 217-524-3034  
Email: [Wei.Han@Illinois.gov](mailto:Wei.Han@Illinois.gov)

---

**From:** Jake Nims <jnims@fwieng.com>  
**Sent:** Thursday, August 13, 2020 2:56 PM



NO.	DATE	BY	DESCRIPTION	CHKD.
1	11/11/11	...	...	...
2	11/11/11	...	...	...
3	11/11/11	...	...	...
4	11/11/11	...	...	...
5	11/11/11	...	...	...
6	11/11/11	...	...	...
7	11/11/11	...	...	...
8	11/11/11	...	...	...
9	11/11/11	...	...	...
10	11/11/11	...	...	...
11	11/11/11	...	...	...
12	11/11/11	...	...	...
13	11/11/11	...	...	...
14	11/11/11	...	...	...
15	11/11/11	...	...	...
16	11/11/11	...	...	...
17	11/11/11	...	...	...
18	11/11/11	...	...	...
19	11/11/11	...	...	...
20	11/11/11	...	...	...
21	11/11/11	...	...	...
22	11/11/11	...	...	...
23	11/11/11	...	...	...
24	11/11/11	...	...	...
25	11/11/11	...	...	...
26	11/11/11	...	...	...
27	11/11/11	...	...	...
28	11/11/11	...	...	...
29	11/11/11	...	...	...
30	11/11/11	...	...	...
31	11/11/11	...	...	...
32	11/11/11	...	...	...
33	11/11/11	...	...	...
34	11/11/11	...	...	...
35	11/11/11	...	...	...
36	11/11/11	...	...	...
37	11/11/11	...	...	...
38	11/11/11	...	...	...
39	11/11/11	...	...	...
40	11/11/11	...	...	...
41	11/11/11	...	...	...
42	11/11/11	...	...	...
43	11/11/11	...	...	...
44	11/11/11	...	...	...
45	11/11/11	...	...	...
46	11/11/11	...	...	...
47	11/11/11	...	...	...
48	11/11/11	...	...	...
49	11/11/11	...	...	...
50	11/11/11	...	...	...
51	11/11/11	...	...	...
52	11/11/11	...	...	...
53	11/11/11	...	...	...
54	11/11/11	...	...	...
55	11/11/11	...	...	...
56	11/11/11	...	...	...
57	11/11/11	...	...	...
58	11/11/11	...	...	...
59	11/11/11	...	...	...
60	11/11/11	...	...	...
61	11/11/11	...	...	...
62	11/11/11	...	...	...
63	11/11/11	...	...	...
64	11/11/11	...	...	...
65	11/11/11	...	...	...
66	11/11/11	...	...	...
67	11/11/11	...	...	...
68	11/11/11	...	...	...
69	11/11/11	...	...	...
70	11/11/11	...	...	...
71	11/11/11	...	...	...
72	11/11/11	...	...	...
73	11/11/11	...	...	...
74	11/11/11	...	...	...
75	11/11/11	...	...	...
76	11/11/11	...	...	...
77	11/11/11	...	...	...
78	11/11/11	...	...	...
79	11/11/11	...	...	...
80	11/11/11	...	...	...
81	11/11/11	...	...	...
82	11/11/11	...	...	...
83	11/11/11	...	...	...
84	11/11/11	...	...	...
85	11/11/11	...	...	...
86	11/11/11	...	...	...
87	11/11/11	...	...	...
88	11/11/11	...	...	...
89	11/11/11	...	...	...
90	11/11/11	...	...	...
91	11/11/11	...	...	...
92	11/11/11	...	...	...
93	11/11/11	...	...	...
94	11/11/11	...	...	...
95	11/11/11	...	...	...
96	11/11/11	...	...	...
97	11/11/11	...	...	...
98	11/11/11	...	...	...
99	11/11/11	...	...	...
100	11/11/11	...	...	...

Electronic Filing: Received, Clerk's Office 1/8/2021 \*\*PCB 2021-05

PROBST GRAIN & LIVESTOCK, INC.  
 2765 EAST 1400th AVENUE  
 WHEELER, IL 62429

S-101  
 SHEET  
 CONTRACT

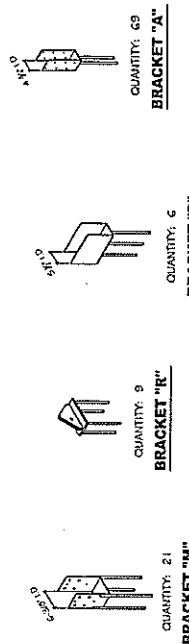

ALL BRACKETS, IMMEDIATELY ADJACENT WALLS SET IN CONCRETE BY CONTRACTOR AT LOCATIONS SHOWN ON S-101. DIMENSIONS INDICATED BY DIMENSION LINES.

**IMPORTANT NOTE TO CONCRETE CONTRACTOR:**  
 CONCRETE CONTRACTOR SHALL COMPLY WITH THE RECOMMENDATIONS AND REQUIREMENTS SET FORTH BY THE AMERICAN CONCRETE INSTITUTE (ACI) FOR THIS SCOPE OF WORK, INCLUDING THE INSTALLATION OF THIS WORK TO THE LAYOUT AND VERIFIED SURVEY IN ACCORDANCE WITH THE SPECIFICATIONS INDICATED ON THESE DRAWINGS. CONCRETE CONTRACTOR SHALL INSTALL ALL IMBEDDED COMPONENTS AND ANCHOR BOLTS IN CONFORMANCE WITH THE SPECIFICATIONS AND REQUIREMENTS OF THE AMERICAN CONCRETE INSTITUTE (ACI). CONCRETE CONTRACTOR SHALL VERIFY THE AS-BUILT CONDITIONS AND COORDINATE WITH THE GENERAL CONTRACTOR TO VERIFY THE AS-BUILT CONDITIONS AND COORDINATE WITH THE GENERAL CONTRACTOR TO VERIFY THE AS-BUILT CONDITIONS. ANY DEVIATIONS, NOT PREVIOUSLY APPROVED, BETWEEN THE CONCRETE SPOKE OF WORK AND THE SUCCESSOR INSTALL ACTIVITIES IS UNACCEPTABLE AND SUBJECT TO ALL BACKCHARGE COSTS TO REMEDY THE DEVIATION.

**CONCRETE SLAB FINISH LEGEND**

- 1 - CONCRETE SLAB FINISH - FULL FINISH (F.F.)
- 2 - CONCRETE SLAB FINISH - POLISHED (P.F.)
- 3 - CONCRETE SLAB FINISH - BROOM FINISH (B.F.)
- 4 - CONCRETE SLAB FINISH - EXPOSED AGGREGATE (E.A.)
- 5 - CONCRETE SLAB FINISH - SAND FINISH (S.F.)
- 6 - CONCRETE SLAB FINISH - SAND FINISH WITH COORDINATE FINISH (S.F. COORD.)

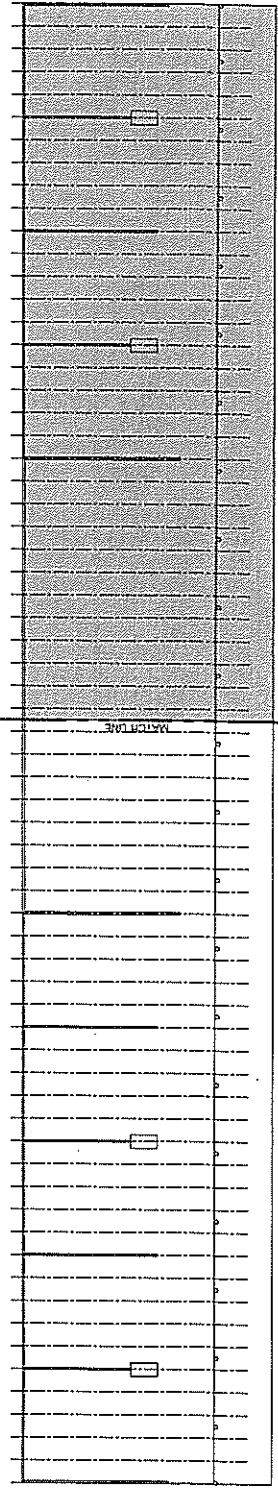
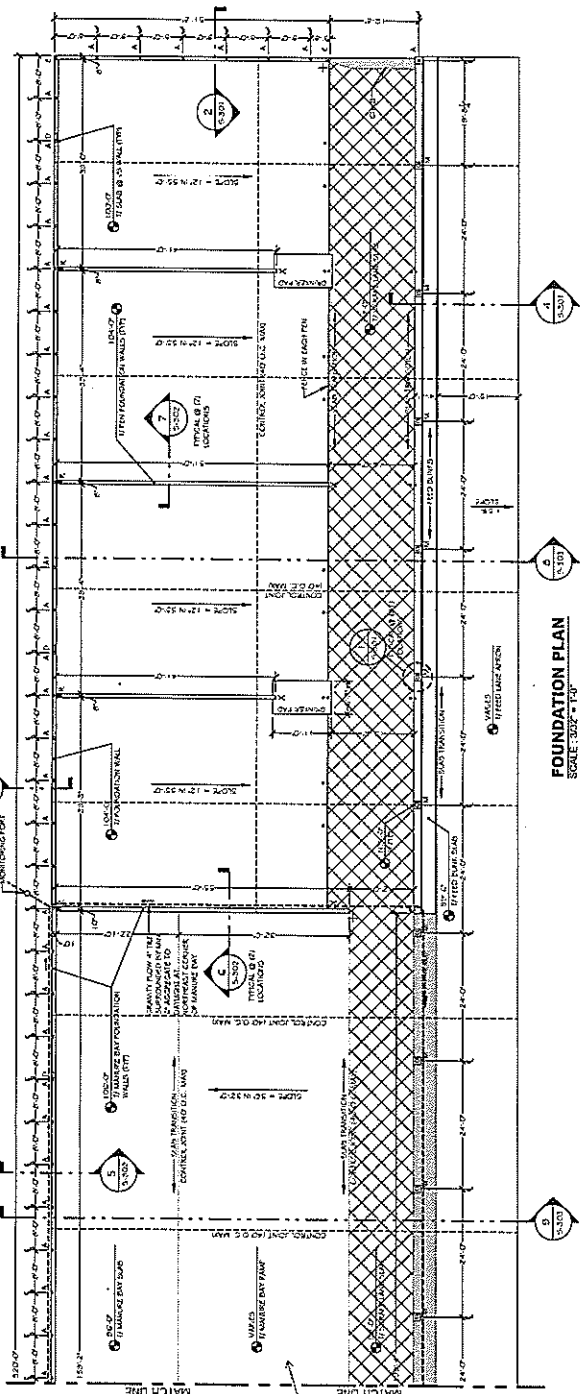

KEY PLAN  
 SCALE: 1" = 20'-0"

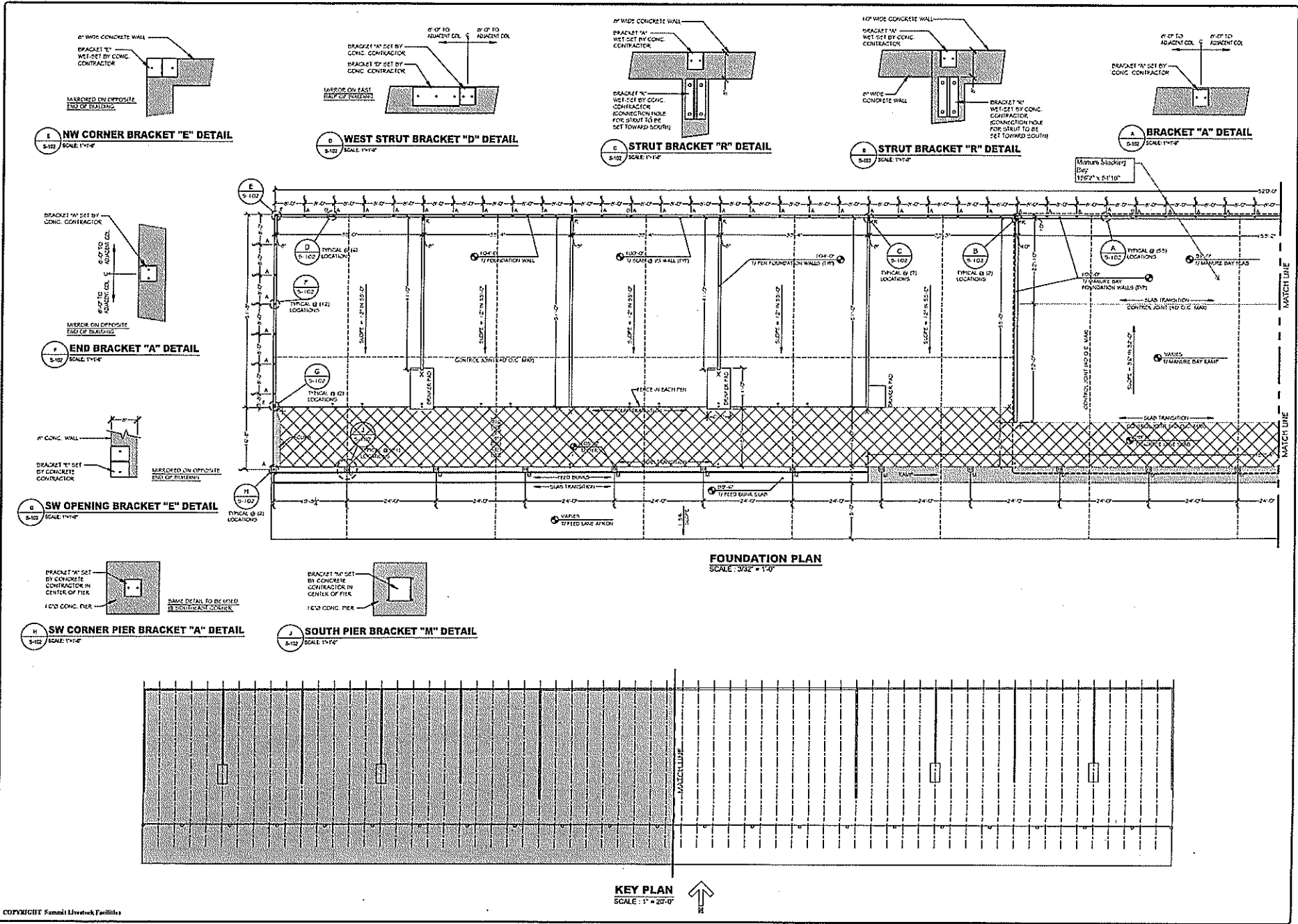

NO.	DATE	BY	DESCRIPTION
1	12/15/20	LL	ISSUED FOR PERMITS
2	05/12/21	LL	ISSUED FOR PERMITS
3	05/12/21	LL	ISSUED FOR PERMITS
4	05/12/21	LL	ISSUED FOR PERMITS
5	05/12/21	LL	ISSUED FOR PERMITS
6	05/12/21	LL	ISSUED FOR PERMITS
7	05/12/21	LL	ISSUED FOR PERMITS
8	05/12/21	LL	ISSUED FOR PERMITS
9	05/12/21	LL	ISSUED FOR PERMITS
10	05/12/21	LL	ISSUED FOR PERMITS
11	05/12/21	LL	ISSUED FOR PERMITS
12	05/12/21	LL	ISSUED FOR PERMITS
13	05/12/21	LL	ISSUED FOR PERMITS
14	05/12/21	LL	ISSUED FOR PERMITS
15	05/12/21	LL	ISSUED FOR PERMITS
16	05/12/21	LL	ISSUED FOR PERMITS
17	05/12/21	LL	ISSUED FOR PERMITS
18	05/12/21	LL	ISSUED FOR PERMITS
19	05/12/21	LL	ISSUED FOR PERMITS
20	05/12/21	LL	ISSUED FOR PERMITS

**PROBST GRAIN & LIVESTOCK, INC.**  
 2765 EAST 140th AVENUE  
 WHEELER, IL 62479

SHEET TITLE  
 FOUNDATION PLAN

ENGINE NAME	1211225.dwg
ENGINE START DATE	05-12-15
DRAWN BY	LL
CHKD BY	LL
DATE	
<b>S-102</b>	
PROJECT NO.	1211225

PROBST GRAIN & LIVESTOCK, INC.  
 2765 EAST 1400 AVENUE  
 WHEELER, IL 62479

NO.	DATE	BY	DESCRIPTION	CHKD.
1	11/11/20	WJS	FOUNDATION PERMITS	
2	11/11/20	WJS	FOUNDATION PERMITS	
3	11/11/20	WJS	FOUNDATION PERMITS	
4	11/11/20	WJS	FOUNDATION PERMITS	
5	11/11/20	WJS	FOUNDATION PERMITS	
6	11/11/20	WJS	FOUNDATION PERMITS	
7	11/11/20	WJS	FOUNDATION PERMITS	
8	11/11/20	WJS	FOUNDATION PERMITS	
9	11/11/20	WJS	FOUNDATION PERMITS	
10	11/11/20	WJS	FOUNDATION PERMITS	

PROJECT NAME	Summit Livestock Facilities
DATE	11/11/20
DRAWN BY	WJS
CHECKED BY	WJS
SCALE	AS SHOWN
SHEET	S-301
PROJECT NO.	2020-001

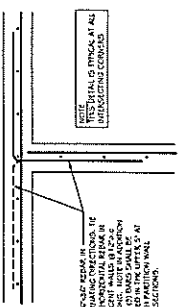
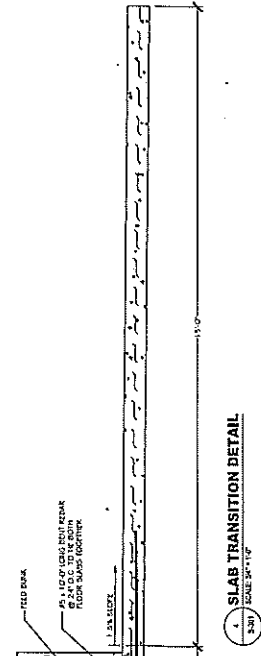
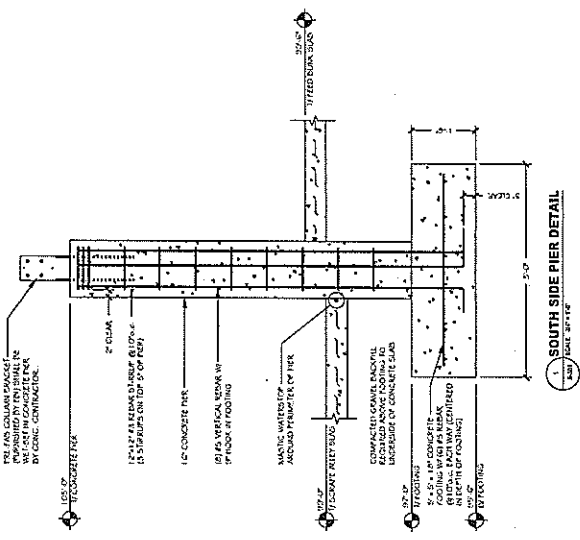
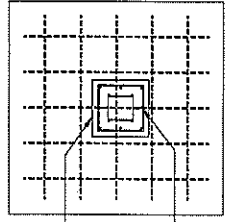

SECTION @ PEN DIVIDER INTERSECTION  
 SCALE 3/4" = 1'-0"

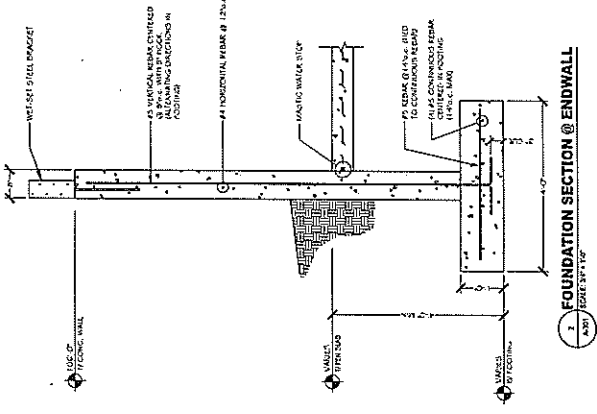

FOUNDATION SECTION @ ENDWALL  
 SCALE 3/4" = 1'-0"

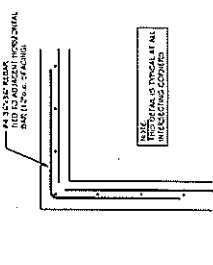

SECTION @ FOUNDATION CORNERS  
 SCALE 3/4" = 1'-0"

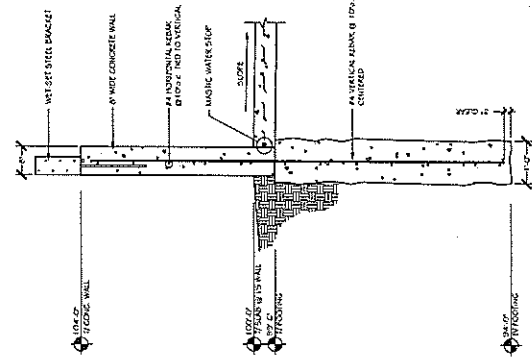

NORTH FOUNDATION SECTION  
 SCALE 3/4" = 1'-0"

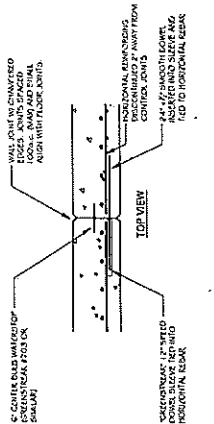

TYPICAL WALL CONSTRUCTION/CONTROL JOINT DETAIL  
 SCALE 1/4" = 1'-0"

CONTRACT: Summit Livestock Facilities

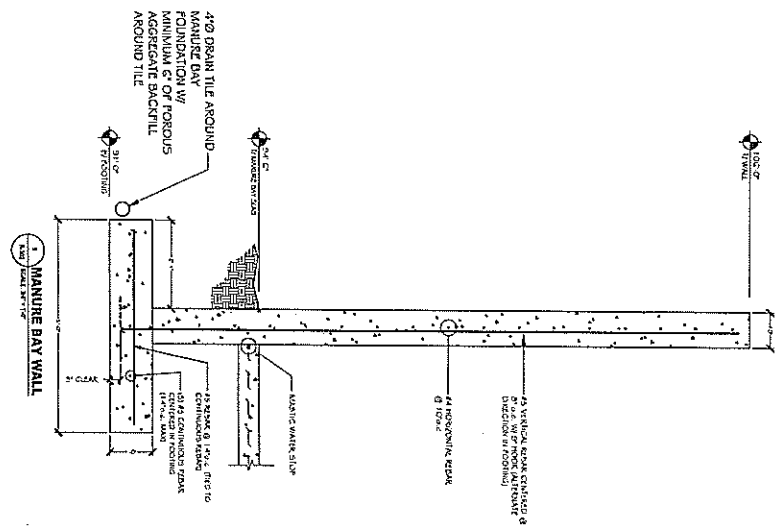
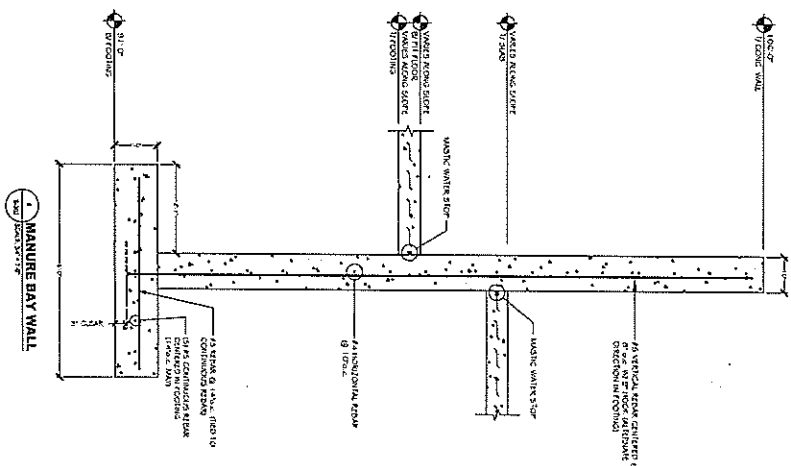
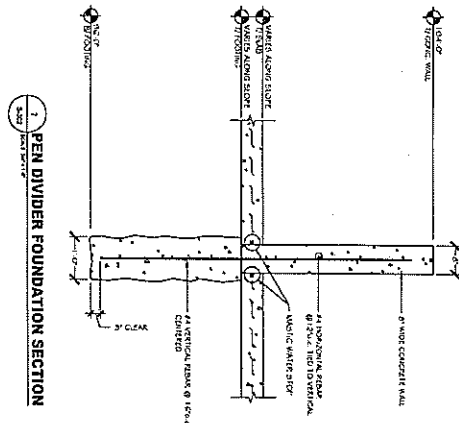

SEAL

**S-302**

PROJECT: 2765 EAST 1400th AVENUE  
 WHEELER, IL 62479

DATE: 1/8/2021

BY: [Signature]

CHKD: [Signature]

**Summit Livestock Facilities**

Maximizing Your Profit Potential

SummitLivestock.com • (800) 213-0567

**PROBST GRAIN & LIVESTOCK, INC.**

2765 EAST 1400th AVENUE  
 WHEELER, IL 62479

SHEET TITLE:  
 FOUNDATION DETAILS

NO.	DATE	BY	DESCRIPTION	CHKD
1	01-08-21	AK	Added perimeter wall to enclosure plan	
2	01-14-21	RB	Change to pen	
3	01-24-21	AK	Change to pen for EDC & animal driveway	
4	02-26-21	AK	REVISION	
5	03-18-21	AK	REVISION SET OF 1000AM VIEWS	
6	03-24-21	AK	Finalization of foundation details	
7	05-13-21	AK	REVISION FOR THE 1000AM VIEWS TO WED	
8	06-23-21	AK	REVISION SET OF 1000AM VIEWS TO WED	
9	08-18-21	AK	REVISION SET	

NO.	DATE	BY	DESCRIPTION	CHG.
1			ISSUED FOR PERMITS	
2			ISSUED FOR PERMITS	
3			ISSUED FOR PERMITS	
4			ISSUED FOR PERMITS	
5			ISSUED FOR PERMITS	
6			ISSUED FOR PERMITS	
7			ISSUED FOR PERMITS	
8			ISSUED FOR PERMITS	
9			ISSUED FOR PERMITS	
10			ISSUED FOR PERMITS	

**Electronic Filing:** Received, Clerk's Office 1/8/2021

**PROBST GRAIN & LIVESTOCK, INC.**  
 2765 EAST 1400th AVENUE  
 WHEELER, IL 62479  
 PHONE: (618) 438-1111  
 FAX: (618) 438-1112  
 EMAIL: PROBST@PROBSTGRAIN.COM

**Summit Livestock Facilities**  
 SummitLivestock.com • (800) 213-0567  
 550-01-0522 PCB 2021-0522  
 PROJECT NAME: SUMMIT LIVESTOCK FACILITIES  
 PROJECT NUMBER: 550-01-0522  
 SHEET: S-303  
 DATE: 1/8/2021

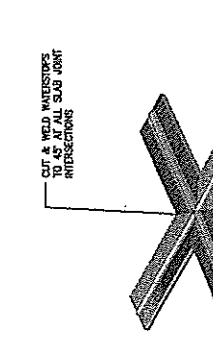
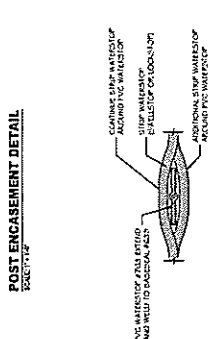
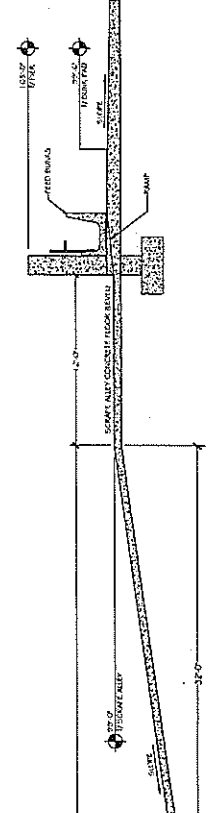
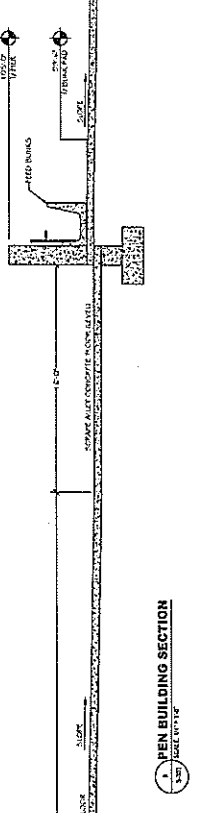
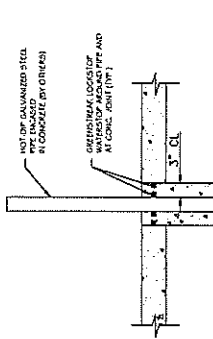
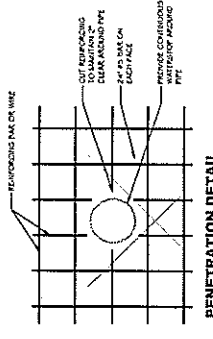
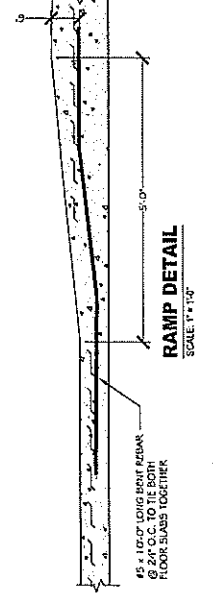
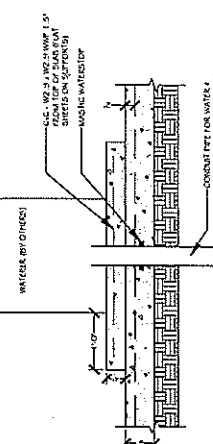
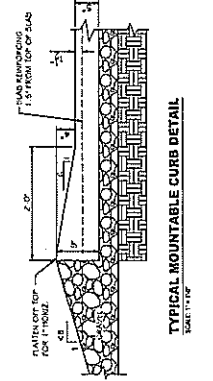
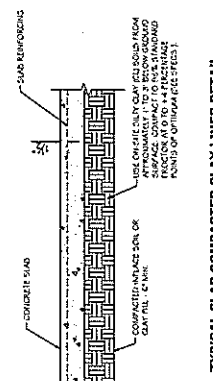
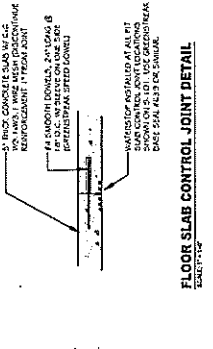
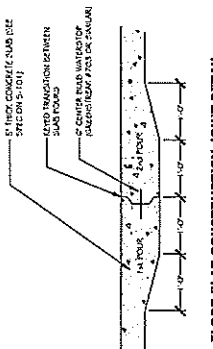

**Han, Wei**

---

**From:** Jake Nims <jnims@fwieng.com>  
**Sent:** Thursday, August 13, 2020 2:56 PM  
**To:** Han, Wei  
**Subject:** [External] Probst Grain & Livestock TC-139041  
**Attachments:** 124199 09-08-15 Foundation Set.pdf

Mr. Han,

This email is in response to your letter dated August 7, 2020, in which 3 items were requested for the Probst Grain & Livestock tax certification.

1. Section number of the prosperity's legal description; Section 9
2. A plan view drawing of the manure stacking area with dimensions and construction material; Plans for the structure are attached to this email
3. A statement whether animals have access to the manure stacking area. Animals do not have access to the manure stacking areas.

Please let me know if you have any other questions.

Jake Nims  
Frank & West Environmental Engineers, Inc.  
1032 S. 2nd St.  
Springfield, IL 62704  
(217) 679-7361 office  
(217) 679-8362 fax  
(309) 530-2894 cell



## ILLINOIS ENVIRONMENTAL PROTECTION AGENCY

1021 NORTH GRAND AVENUE EAST, P.O. BOX 19276, SPRINGFIELD, ILLINOIS 62794-9276 • (217) 782-3397

JB PRITZKER, GOVERNOR

JOHN J. KIM, DIRECTOR

217/782-0610

August 7, 2020

Mr. Jacob Nims  
Frank & West Environmental Engineering, Inc.  
1032 S. 2<sup>nd</sup> St.  
Springfield, IL 62704

Re: Illinois Property Tax: Probst Grain & Livestock – Wheeler  
Livestock Waste Pollution Control Facilities  
Log No. TC-139041

Dear Mr. Nims:

The application for Illinois Property Tax Certification received December 26, 2017 for the above listed facilities has been reviewed and the following information is missing from the application:

1. Section number of the prosperity's legal description;
2. A plan view drawing of the manure stacking area with dimensions and construction material; and
3. A statement whether animals have access to the manure stacking area.

Please provide the information listed above so the Agency can complete the review of the subject application. Please include the above log number on all correspondence. If you have any questions or comments concerning the above items, please contact me at 217-782-0610.

Very truly yours,

A handwritten signature in black ink, appearing to read "Wei Han".

Wei Han  
BOW/DWPC/Permit Section  
Illinois Environmental Protection Agency

WH:TC-139041.doc

cc: WH File



**Frank & West**  
Environmental Engineers, Inc.

October 26, 2017

Al Keller  
Permit Section  
Division of Water Pollution Control  
Illinois EPA  
P.O. Box 19276  
Springfield, Illinois 62794-9276

RE: Probst Grain & Livestock facility

Dear Mr. Keller:

Frank & West is submitting an application for certification of property tax treatment for pollution control facility on behalf of the Probst Grain & Livestock facility.

If you have any further questions or comments regarding the Probst Grain & Livestock non-lagoon livestock waste handling facility, please advise.

**FRANK & WEST**  
**ENVIRONMENTAL ENGINEERS, INC.**

A handwritten signature in black ink, appearing to read 'Jacob Nims', is written over the printed name.

Jacob Nims  
Agricultural Engineer

Attachment: Application for Certification

**RECEIVED**  
DEC 26 2017  
IEPA  
BOW/WPC/PERMIT SECTION



ATTACHMENT A

PROBST GRAIN & LIVESTOCK TAX CERTIFICATION FORM



TC-137091

# Illinois Environmental Protection Agency

1021 North Grand Avenue East • P.O. Box 19276 • Springfield • Illinois • 62794-9276 • (217) 782-3397

## Application for Certification (Property Tax Treatment) Pollution Control Facility

### FOR AGENCY USE ONLY

File Number: _____	Date Rec'd: _____
Certification Number: _____	Date: _____

Facility Type (check one):  Air  Water

This form is to be used for any application for certification of property tax treatment for a pollution control facility for air or water from the Illinois EPA. Separate applications must be completed for each control facility claimed. Do not mix types (air and water). Where both air and water operations are related, file two applications.

You must have Adobe Acrobat Reader 10 or above installed to use the features on this form.

If attachments are needed, record them consecutively on an index sheet.

You may complete this form online, save a copy locally, print, sign and submit it to:

Illinois EPA  
Attention: Al Keller, Permit Section  
Division of Water Pollution Control  
1021 North Grand Avenue East, P.O. Box 19276  
Springfield, IL 62794-9276

### I. Applicant Information:

Company Name: <u>Probst Grain &amp; Livestock</u>	Person to Contact _____
Person Authorized to Receive Certification: <u>Randall Probst</u>	for Additional Details: <u>Same</u>
Street Address: <u>1977 E. 1500th Ave.</u>	Street Address: _____
City: <u>Wheeler</u> State: <u>IL</u>	City: _____ State: _____
Zip: <u>62479</u> Phone: <u>217-925-5120</u>	Zip: _____ Phone: _____
Email Address: _____	Email Address: _____

### II. Facility Information:

Facility Location: Quarter Section: SE Township: 7-North Range: 8-East  
Municipality: \_\_\_\_\_ Township: \_\_\_\_\_

Address: \_\_\_\_\_ City: \_\_\_\_\_  
State: \_\_\_\_\_ Zip Code: \_\_\_\_\_ County: Jasper Book Number: \_\_\_\_\_

Property Index Number: \_\_\_\_\_

Note: The Property Index Number is the numerical reference used to identify a parcel of real property for assessment and taxation purposes.

### Manufacturing Operations Information:

Nature of Operations Conducted at the Above Location:

The structure is a beef bedpack barn with 9 bedpack areas and 1 dedicated manure stacking area.

### Permit Information:

WPC Construction Permit Number: _____	N/A	Date Issued: _____	
NPDES Permit Number: _____	N/A	Date Issued: _____	Exp. Date: _____
APC Construction Permit Number: _____	N/A	Date Issued: _____	
APC Operating Permit Number: _____	N/A	Date Issued: _____	Exp. Date: _____

Note: Submit copies of all relevant permits issued by local pollution control agencies. (e.g. MSD Construction Permit)

This Agency is authorized to request this information under 415 ILCS 5/4(b)(2012). Disclosure of this information is voluntary and no penalties will result from the failure to provide the information. However, the absence of the information could prevent your application from being processed or could result in denial of your application.

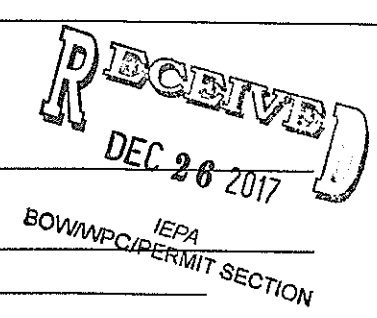

**Manufacturing Process Information:**

Please provide information on the manufacturing process and materials on which pollution control facility is used, including each major piece of equipment associated with the pollution control facility (or low sulfur dioxide emission coal fueled device).  
Description of the Process:

Not applicable

**RECEIVED**  
DEC 26 2017

**Materials Used in the Process:**

Not applicable

IEPA  
BOWWPC/PERMIT SECTION

**Pollution Control Facility Information:**

Please provide a narrative description of the pollution control facility (or low sulfur dioxide emission coal fueled device), and an explanation of why its primary purpose is to eliminate, prevent or reduce pollution. State the type of control facility, as well as a narrative description and a process flow diagram describing the pollution control facility. Include an average analysis of the influent and effluent of the control facility stating the collection efficiency, if applicable.

Describe the Pollution Control Facility (or Low Sulfur Dioxide Emission Coal Fueled Device):

**Beef Bedpack:** A manure stacking area measuring 159.167' x 54.833' x 6' high is used to store livestock waste until the appropriate time to apply the manure at agronomic rates.

Describe the Primary Purpose of the Pollution Control Facility (or Low Sulfur Dioxide Emission Coal Fueled Device):

The primary purpose of the bedpack barn and stacking area is to have 191 days worth of livestock manure storage to allow flexibility for application to agricultural fields when conditions are ideal.

Identify the statute or regulation (federal or state), or local ordinance, if any, requiring the installation of the subject pollution control facility (or low sulfur dioxide emission coal fueled device).

Not applicable

**Nature of Contaminants or Pollutants:**

List air contaminants or water pollution substances released as effluents to the manufacturing processes. Also list the final disposal of any contaminants removed from the manufacturing processes.

Contaminant or Pollutant	Material Retained, Captured or Recovered	
	Description	Disposal or Use
Livestock Manure	Stored in a dedicated stacking area	Field applied at agronomic rates

Note: Contaminant or pollutant means that which is removed from the process by the pollution control facility.



**Point(s) of Waste Water Discharge:**

Identify the location of the discharge to the receiving stream. This will typically refer to a source of water pollution but can include water-carried wastes from air pollution control facilities.  
1021 North Grand Avenue East P.O. Box 19278 Springfield Illinois 62764-0278 (217) 782-3397

Plans and Specifications Attached  Yes  No

Submit Drawings, which clearly show:

- (a) Point(s) of discharge to receiving stream; and
- (b) Sewers and process piping to and from the control facility.

**Are contaminants (or residues) collected by the control facility?**  Yes  No

Note: If the collected contaminants are disposed of other than as wastes, state the disposition of the materials, and the value dollars reclaimed by the sale or reuse of the collected substances. State the cost of reclamation and related expense.

**Project Status:**

Date Installation Completed: \_\_\_\_\_

Provide the date the pollution control facility was first placed into service and operated. If not, explain.

Status of installation on date of application:

**III. Verification and Signature:**

The following information is submitted in accordance with the Illinois Property Tax Code, as amended, and to the best of my knowledge is true and correct.

**Any person who knowingly makes a false, fictitious, or fraudulent material statement, orally or in writing, to the Illinois EPA commits a Class 4 felony. A second or subsequent offense after conviction is a Class 3 felony. (415 ILCS 5/44(h))**

Chris A. Probst  
Printed Name:

V.P.  
Title:

For incorporated entities, signature should be from an authorized corporate representative.

Chris A. Probst  
Signature:

12-21-17  
Date:

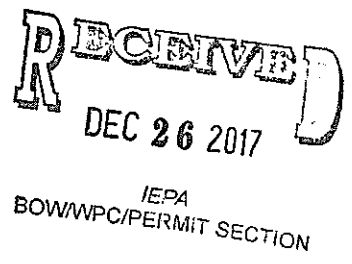

POLLUTION CONTROL FACILITY  
PROCESS FLOW DIAGRAM

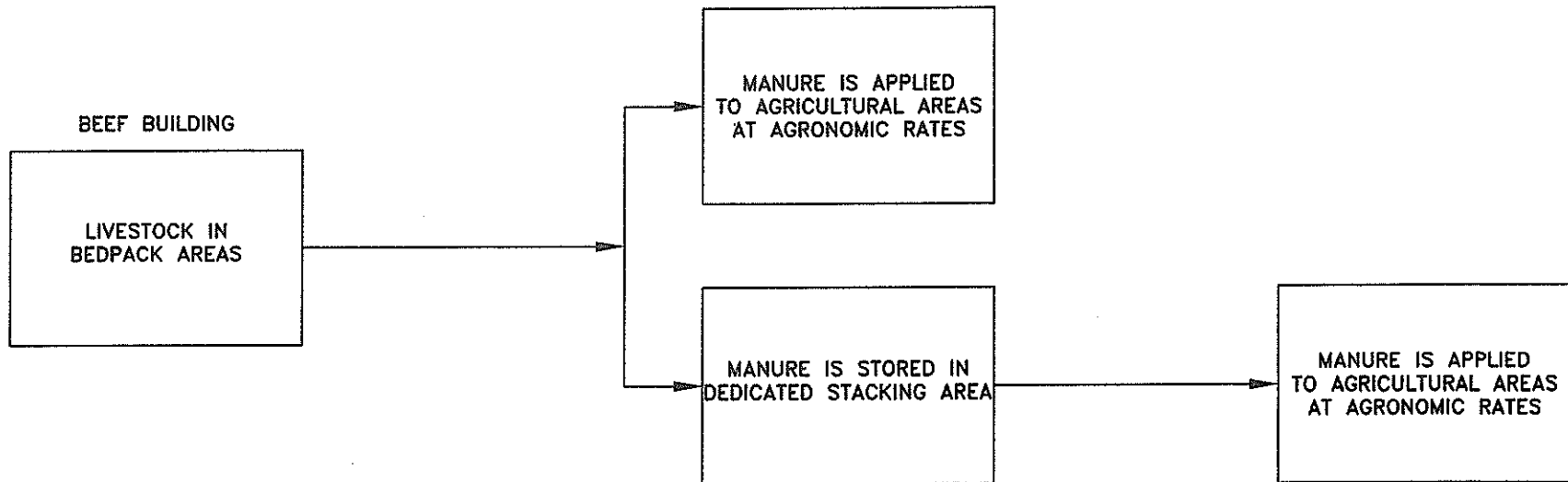

ATTACHMENT B  
HIGHLIGHTED TAX CERTIFICATION FORM

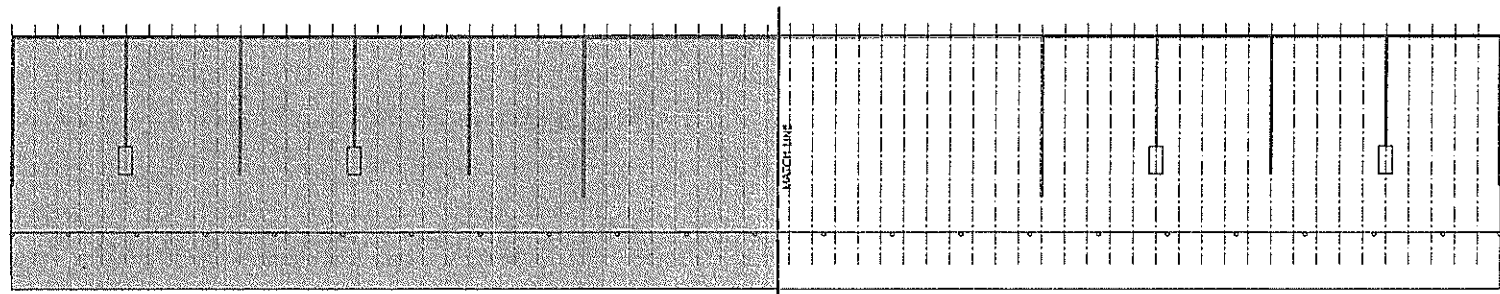
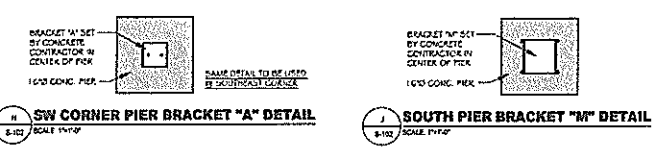
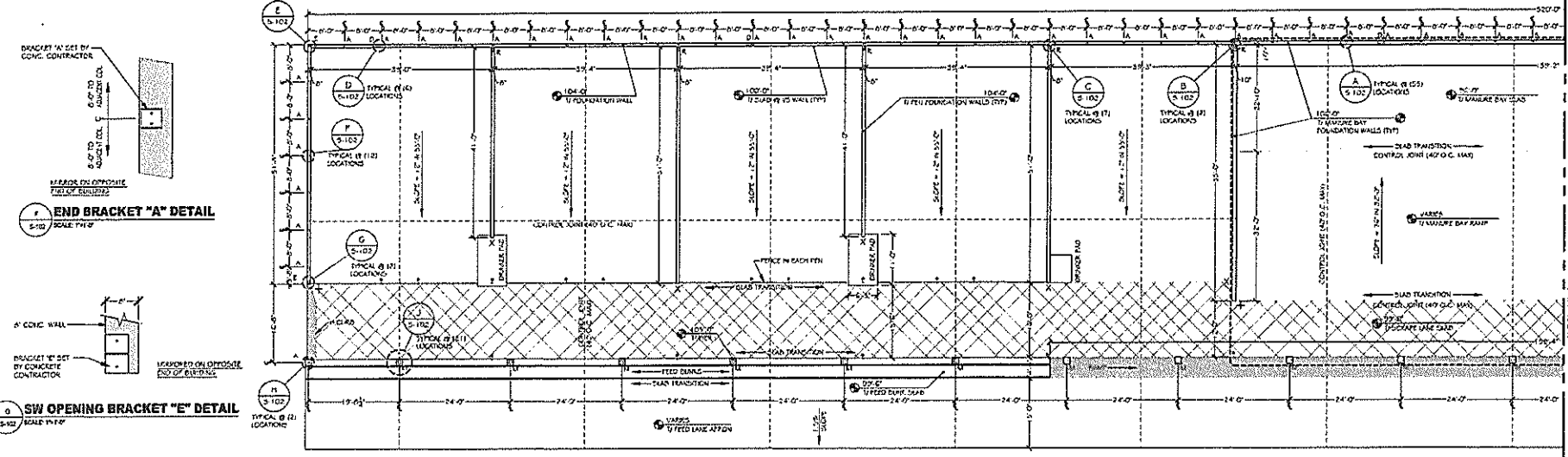
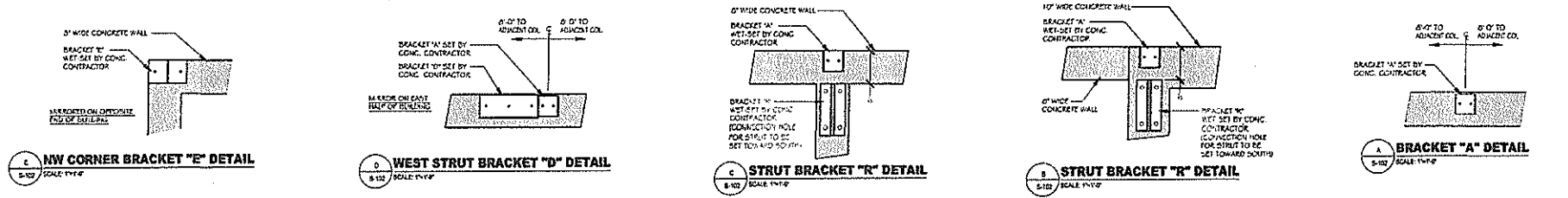

NO.	DATE	BY	DESCRIPTION	CHECKED
1				
2				
3				
4				
5				
6				
7				
8				
9				
10				

**PROBST GRAM & LIVESTOCK, INC.**  
2765 EAST LAURA AVENUE  
WHEELER, UT 84419

SHEET TITLE  
**FOUNDATION PLAN**

DATE PLOTTED	12/15/20
DATE PRINTED	06-12-15
DATE PLOTTED	06-12-15
DATE PRINTED	06-12-15
SCALE	EL
SHEET	S-102
PROJECT #	124199

NO.	DATE	BY	DESCRIPTION	CHKD.
1				
2				
3				
4				
5				
6				
7				
8				
9				
10				
11				
12				
13				
14				
15				
16				
17				
18				
19				
20				

**PROBST GRAIN & LIVESTOCK, INC.**  
 2765 EAST 1490th AVENUE  
 DENVER, CO 80202  
 FOUNDATION PLAN

Filing: Received, Clerk's Office 1/8/2021\*\* PCB 2021-052

**S-101**  
 SHEET  
 CONSTRUCTION  
 PROJECT:

**BRACKET "A"**  
QUANTITY: 63

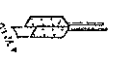

**BRACKET "D"**  
QUANTITY: 6

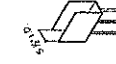

**BRACKET "R"**  
QUANTITY: 9



**BRACKET "M"**  
QUANTITY: 21



**BRACKET "E"**  
QUANTITY: 4

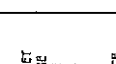

ALL SPACED 4" UNLESS NOTED OTHERWISE. ALL REINFORCEMENT SHALL BE SET ACCORDING TO THIS PLAN UNLESS INDICATED OTHERWISE.

**CONCRETE FINISH LEGEND**

- SMOOTH FINISH
- FORMED FINISH
- PARALLEL LINE TEXTURED FINISH

**GATE EMBED PLATE LEGEND**

- 1. BRACKET EMBEDMENT
- 2. BRACKET EMBEDMENT
- 3. BRACKET EMBEDMENT
- 4. BRACKET EMBEDMENT
- 5. BRACKET EMBEDMENT

**REINFORCING BARS**

- REINFORCING BARS
- REINFORCING BARS
- REINFORCING BARS

REINFORCEMENT SHALL BE SET ACCORDING TO THIS PLAN UNLESS INDICATED OTHERWISE.

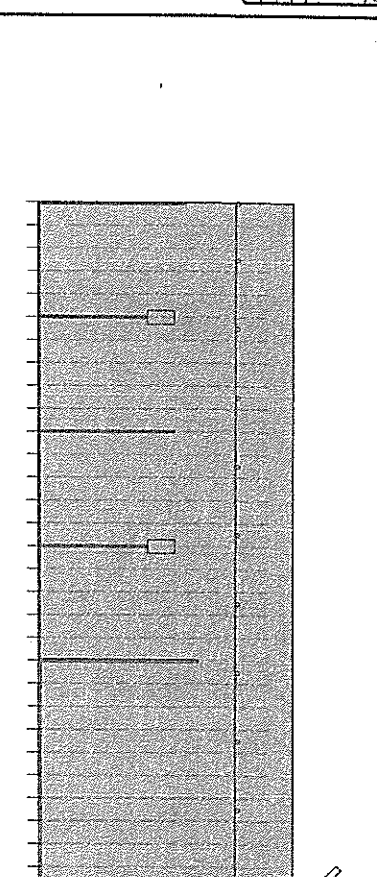
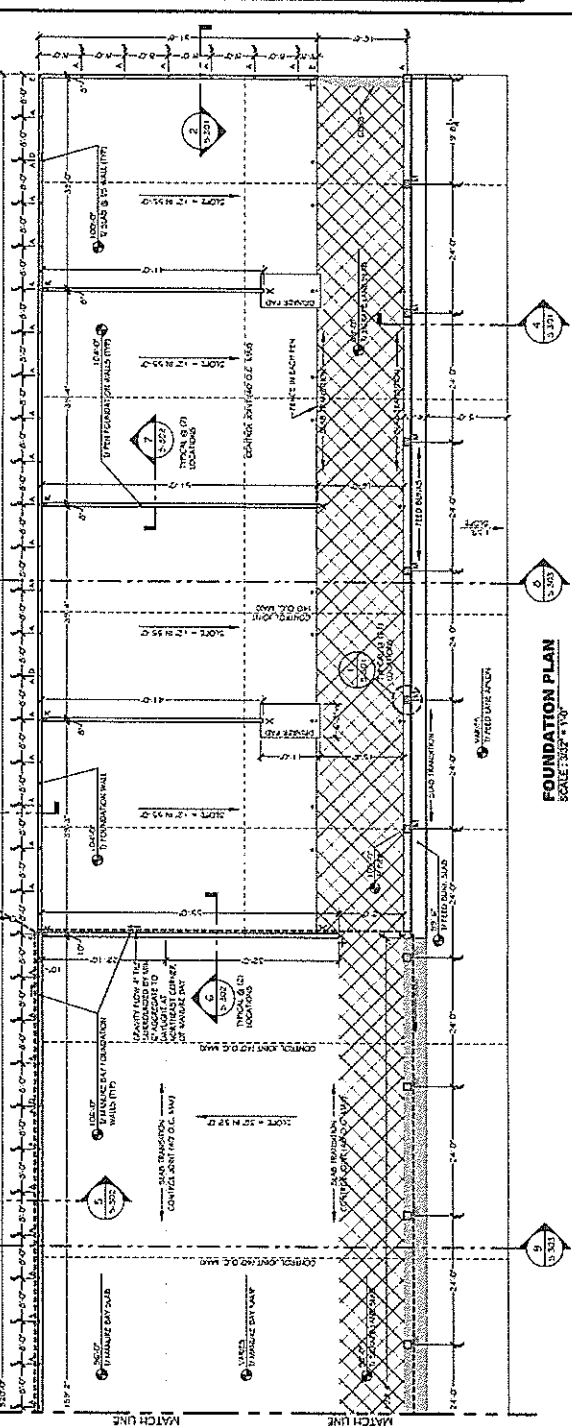

**KEY PLAN**  
SCALE: 1" = 20'

- CONCRETE**
1. All concrete work shall conform to the current or referenced codes of Building Code Requirements for Reinforced Concrete, ACI 318, Specification for Structural Concrete for Buildings, ACI 301, Manual of Standard Practice for Dewatering Reinforced Concrete Structures, ACI 308, and other relevant codes and standards, unless otherwise specified.
  2. Completed work shall not vary from the plans or field notes by 1/4" in 10 feet.
  3. Top of concrete elevations shall not deviate more than 1/4" from specified elevations on plans.
  4. All reinforcement bars shall comply with the recommendations and requirements set forth by the American Concrete Institute (ACI) for this scope of work, including the installation of this work to the layout and verified survey in accordance with the specifications indicated on these drawings. Concrete contractor shall install all embedded components and anchor bolts in conformity with the specifications indicated on these drawings, prior to and after concrete placement. Concrete contractor shall verify the assembly condition and coordinate acceptable tolerance results with the general contractor. Any deviations, not previously approved, between the concrete scope of work and the successor install activities is unacceptable and subject to all backcharge costs to remedy the deviation.
  5. All concrete shall have a 28 day strength of 4,000 psi.
  6. Concrete shall be placed in the concrete on the job site.
  7. Concrete shall be 4" x 1/2" x 1/2" subgrade to the concrete on the job site.
  8. Concrete shall be placed in the concrete on the job site.
  9. A curing compound shall be used on exposed surfaces according to accepted manufacturer's specs.
  10. All reinforcement bars shall conform to ASTM A615, grade 60 unless otherwise specified.
  11. All reinforcement bars shall conform to ASTM A615, grade 60 unless otherwise specified.
  12. Reinforcement bars shall be installed in accordance with the specifications indicated on these drawings.
  13. Reinforcement bars shall be installed in accordance with the specifications indicated on these drawings.
  14. All tie bars shall be installed in accordance with the specifications indicated on these drawings.
  15. All tie bars shall be installed in accordance with the specifications indicated on these drawings.
  16. All tie bars shall be installed in accordance with the specifications indicated on these drawings.
  17. All tie bars shall be installed in accordance with the specifications indicated on these drawings.
  18. All tie bars shall be installed in accordance with the specifications indicated on these drawings.
  19. Reinforcement in footings, walls, and beams shall be continuous. Bar bars a minimum of 20% shall be provided in each direction.
  20. Reinforcement shall be installed in accordance with the specifications indicated on these drawings.
  21. Wall to slab transition shall be staggered with the Greenstreet PFC #703 with 3" at least.
  22. Reinforcement connection in walls or joists to match slab construction and control joints (see foundation plan on S-107 for joint spacing). Intersect and seal "v" bar wedge-type per manufacturer between walls and slabs to provide a continuous strength joint. As provided in walls 4 posts shall be spaced perpendicular to alternate walls, increase strength, and increase permeability by means of mechanical isolation.
  23. Allowable soil bearing pressure = 2,000 psf.





1021 North Grand Avenue East • P.O. Box 19276 • Springfield • Illinois • 62794-9276 • (217) 782-3397

**Application for Certification (Property Tax Treatment)  
 Pollution Control Facility**

FOR AGENCY USE ONLY	
File Number: _____	Date Rec'd: _____
Certification Number: _____	Date: _____

Facility Type (check one):  Air  Water

This form is to be used for any application for certification of property tax treatment for a pollution control facility for air or water from the Illinois EPA. Separate applications must be completed for each control facility claimed. Do not mix types (air and water). Where both air and water operations are related, file two applications.

If attachments are needed, record them consecutively on an index sheet.

You may complete this form online, save a copy locally, print, sign and submit it to:

Illinois EPA  
 Attention: Al Keller, Permit Section  
 Division of Water Pollution Control  
 1021 North Grand Avenue East, P.O. Box 19276  
 Springfield, IL 62794-9276

**I. Applicant Information:**

Company Name: _____	Person to Contact _____
Person Authorized to Receive Certification _____	for Additional Details _____
Street Address: _____	Street Address: _____
City: _____ State: _____	City: _____ State: _____
Zip: _____ Phone: _____	Zip: _____ Phone: _____
Email Address: _____	Email Address: _____

**II. Facility Information:**

Facility Location: Quarter Section: \_\_\_\_\_ Township: \_\_\_\_\_ Range: \_\_\_\_\_  
 Municipality: \_\_\_\_\_ Township: \_\_\_\_\_

Note: A plat map location is requested for facilities located outside of municipal boundaries.

Address: 2765 E. 1400<sup>th</sup> Ave. City: Wheeler  
 State: IL Zip Code: 62479 County: Jasper Book Number: \_\_\_\_\_

Property Index Number: 58-06-09-400-002

Note: The Property Index Number is the numerical reference used to identify a parcel of real property for assessment and taxation purposes.

**Manufacturing Operations Information:**

Nature of Operations Conducted at the Above Location:

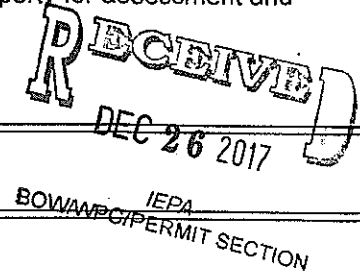

**Permit Information:**

WPC Construction Permit Number: _____	Date Issued: _____
NPDES Permit Number: _____	Date Issued: _____ Exp. Date: _____
APC Construction Permit Number: _____	Date Issued: _____
APC Operating Permit Number: _____	Date Issued: _____ Exp. Date: _____

Note: Submit copies of all relevant permits issued by local pollution control agencies. (e.g. MSD Construction Permit)

*This Agency is authorized to request this information under 415 ILCS 5/4(b)(2012). Disclosure of this information is voluntary and no penalties will result from the failure to provide the information. However, the absence of the information could prevent your application from being processed or could result in denial of your application.*

**Manufacturing Process Information:**

Please provide information on the manufacturing process and materials on which pollution control facility is used, including each major piece of equipment associated with the pollution control facility (or low sulfur dioxide emission coal fueled device).  
Description of the Process:

**Materials Used in the Process:**

**Pollution Control Facility Information:**

Please provide a narrative description of the pollution control facility (or low sulfur dioxide emission coal fueled device), and an explanation of why its primary purpose is to eliminate, prevent or reduce pollution. State the type of control facility, as well as a narrative description and a process flow diagram describing the pollution control facility. Include an average analysis of the influent and effluent of the control facility stating the collection efficiency, if applicable.

Describe the Pollution Control Facility (or Low Sulfur Dioxide Emission Coal Fueled Device):

Describe the Primary Purpose of the Pollution Control Facility (or Low Sulfur Dioxide Emission Coal Fueled Device):

Identify the statute or regulation (federal or state), or local ordinance, if any, requiring the installation of the subject pollution control facility (or low sulfur dioxide emission coal fueled device).

**Nature of Contaminants or Pollutants:**

List air contaminants or water pollution substances released as effluents to the manufacturing processes. Also list the final disposal of any contaminants removed from the manufacturing processes.

Contaminant or Pollutant	Material Retained, Captured or Recovered	
	Description	Disposal or Use

Note: Contaminant or pollutant means that which is removed from the process by the pollution control facility.

**Point(s) of Waste Water Discharge:**

Identify the location of the discharge to the receiving stream. This will typically refer to a source of water pollution but can include water-carried wastes from air pollution control facilities.

Plans and Specifications Attached  Yes  No

Submit Drawings, which clearly show:

- (a) Point(s) of discharge to receiving stream; and
- (b) Sewers and process piping to and from the control facility.

Are contaminants (or residues) collected by the control facility?  Yes  No

Note: If the collected contaminants are disposed of other than as wastes, state the disposition of the materials, and the value dollars reclaimed by the sale or reuse of the collected substances. State the cost of reclamation and related expense.

**Project Status:**

Date Installation Completed: 11-1-15

Provide the date the pollution control facility was first placed into service and operated. If not, explain.

12-23-15
----------

Status of installation on date of application:

operating
-----------

**III. Verification and Signature:**

The following information is submitted in accordance with the Illinois Property Tax Code, as amended, and to the best of my knowledge is true and correct.

**Any person who knowingly makes a false, fictitious, or fraudulent material statement, orally or in writing, to the Illinois EPA commits a Class 4 felony. A second or subsequent offense after conviction is a Class 3 felony. (415 ILCS 5/44(h))**

Chris A. Probst  
Printed Name:

V.P.  
Title:

For incorporated entities, signature should be from an authorized corporate representative.

Chris A. Probst  
Signature:

12-21-17  
Date:

**RECEIVED**  
DEC 26 2017

IEPA  
BOW/WPC/PERMIT SECTION

ATTACHMENT C  
IEPA COVER LETTER

ATTACHMENT  
APPLICATION FOR CERTIFICATION

STATE OF ILLINOIS

)  
)  
)  
)  
)

COUNTY OF SANGAMON

**CERTIFICATE OF SERVICE**

I, the undersigned attorney at law, hereby certify that I have served on the date of January 8, 2021, the attached **NOTICE, APPEARANCE** and **RECOMMENDATION OF THE ILLINOIS ENVIRONMENTAL PROTECTION AGENCY**, upon the following persons by causing to be mailed a true copy thereof in an envelope duly addressed, bearing proper first class postage, and deposited in the United States mail at Springfield, Illinois:

Probst Grain & Livestock-Wheeler  
Randall Probst  
1977 E. 1500th Ave.  
Wheeler, Illinois 62479

**Copies also provided electronically as follows:**

Illinois Department of Revenue  
via email at REV.PropTaxApp@illinois.gov  
101 West Jefferson  
P.O. Box 19033  
Springfield, Illinois 62794

**[Electronic Filing]**

Clerk  
Illinois Pollution Control Board  
James R. Thompson Center  
100 West Randolph Street, Suite. 11-500  
Chicago, Illinois 60601

ILLINOIS ENVIRONMENTAL PROTECTION AGENCY

/s/ Amanda S. Kimmel  
Assistant Counsel  
Division of Legal Counsel  
1021 North Grand Avenue East  
P.O. Box 19276  
Springfield, Illinois 62794-9276  
217.782.5544  
217.782.9143 (TDD)

**THIS FILING IS SUBMITTED ON RECYCLED PAPER**